

INSTALLATION MANUAL

DOC NO. 487 05 47 24 REV. 00
EN (US)



TD100, TD135 Heating unit

Wascomat provides efficient washers, dryers, flatwork ironers and wetcleaning systems in a size and model for every laundry and wetcleaning need!



Wascomat Laundry Equipment

516-371-4400 • www.wascomat.com

FOR PARTS, SERVICE AND TECHNICAL ASSISTANCE CALL YOUR LOCAL WASCOMAT DEALER

WASCOMAT CUSTOMER SUPPORT

Whether you need spare parts or technical advice to guide you to the source of a malfunction, our nationwide network of authorized dealers are able and ready to serve your needs, or call the Wascomat Customer Service Hotlines listed below.

SPARE PARTS

516-371-2000

Before ordering parts, refer to the Wascomat spare parts manual (also available on www.wascomat.com) to determine the part number(s) for the item(s) you need.

For quick service, please have the following information available:

1. Part Number of the item(s) you need.
2. Model of the machine.
3. Serial number of the machine.
4. Electrical data for the machine:
 - 120 or 208-240 Volt?
 - Single or three phase?
 - 50 or 60 Cycle?

To insure parts order accuracy, only fax or email parts orders are accepted:

- Fax: 516-371-4029
- email: parts@wascomat.com

TECHNICAL SUPPORT

516-371-0700

For service information, first contact your local authorized Wascomat dealer.

Wascomat technical support can assist you or your technician to diagnose and repair your laundry machines over the phone. Please call from the location where the machines are installed (we suggest you use a cellular or cordless phone), and have the following information available:

1. Model of the machine.
2. Serial number of the machine.
3. Electrical data for the machine:
 - 120 or 208-240 Volt?
 - Single or three phase?
 - 50 or 60 Cycle?
4. An accurate description of the malfunction.

**To expedite parts order shipment, please use your credit card.
We accept: American Express, Mastercard, Visa, Discover, Diner's Club.**

WARRANTY CLAIMS

Wascomat's Technical Support staff will honor valid manufacturer's parts warranty claims providing your Wascomat machines are registered for warranty coverage upon installation. If they are not registered, you can validate your warranty claim by providing information about when and where you purchased the Wascomat machine(s), the model and serial number(s). Additional warranty proof may also be required.

461 Doughty Blvd., Inwood, N.Y. 11096-0338 | Sales and Administration – Tel: 516-371-4400 • Fax: 516-371-4204 • e-mail: sales@wascomat.com
Spare Parts – Tel: 516-371-2000 • Fax: 516-371-4029 • e-mail: parts@wascomat.com | Technical Support – Tel: 516-371-0700 • Fax: 516-371-4029
En Mexico: Llame gratis a este numero 001-800-010-1010

Contents

Installation: Gas heating unit.....	7
Installation: Electric heating unit	19
Installation: Steam heating unit.....	31

Contents

Gas heating unit installation

Mounting gas heating unit.....	8
Mounting equipment for Sliding Door	15

Note! The procedure when mounting the heating unit is the same on dryers with standard door and with Sliding Door. In this manual all pictures show a standard door except from pages relating specifically to Sliding Door.

The manufacturer reserves the right to modify design and material specifications without notice.

Mounting gas heating unit

Heating unit

The heating unit is to be mounted on top of the dryer.

It is recommended that the mounting is carried out by two persons.

Use the supplied screws.

Unpacking

Unpack the heating unit.

1. Note! During transport side panels and brace are placed in the back of the dryer.

Mounting heating unit

2. Remove top panel for the heating unit from the top of the dryer where it is placed during transport.
3. Demount the two top back panels on the dryer.
4. Lift gas box and place it on top of the dryer.

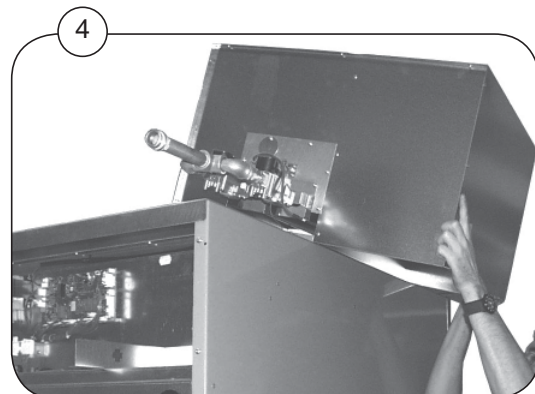
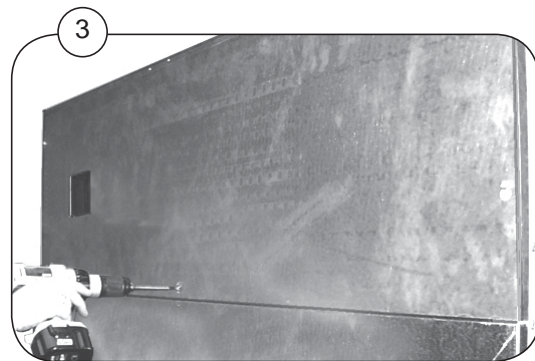
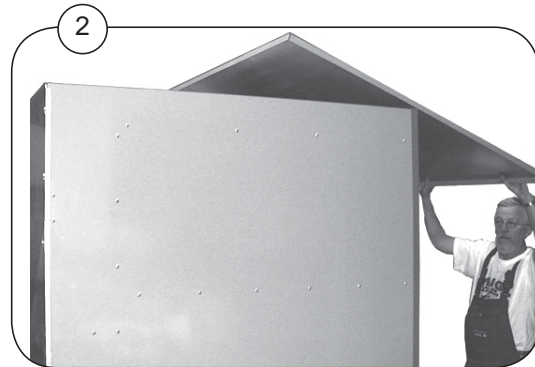

Mounting heating unit

5. Fasten gas box using 7 screws.

Note! If the dryer has Sliding Door **SD**, go to page 16 before carrying out step 6.

6. Fasten brace **A** using 6 screws.

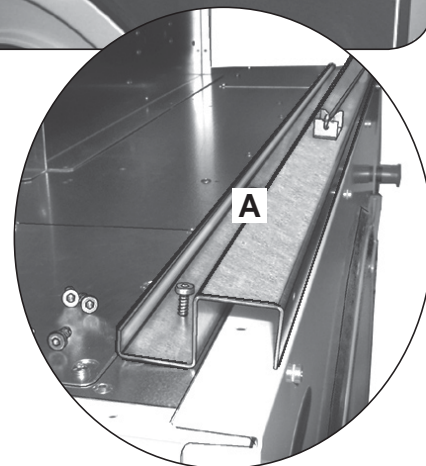
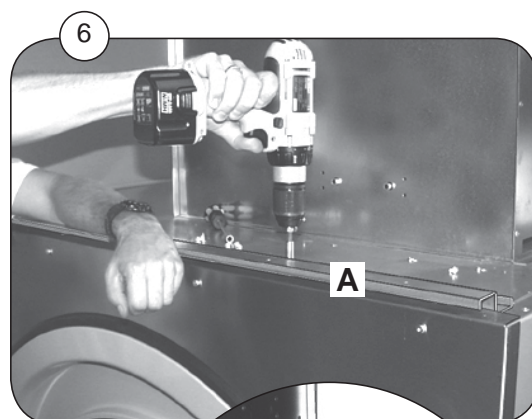
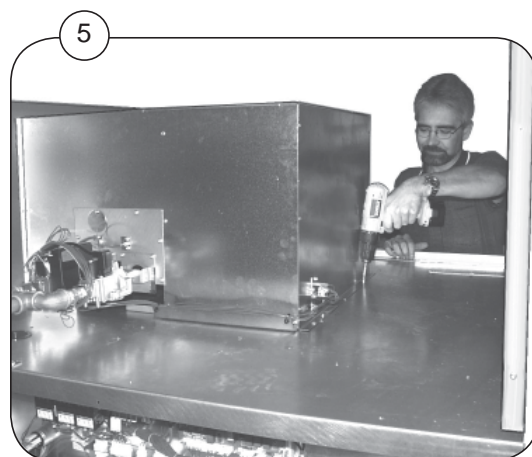

Gas heating unit installation

Mounting heating unit

- Fasten each side panels to the bottom using 5 screws.
7. Turn the side panels with the grooves facing downward. First fasten the front screw and then the back screw but not as far as they will go. Mount the side panels in the grooves and fasten them.
7. Fasten the last 3 screws.

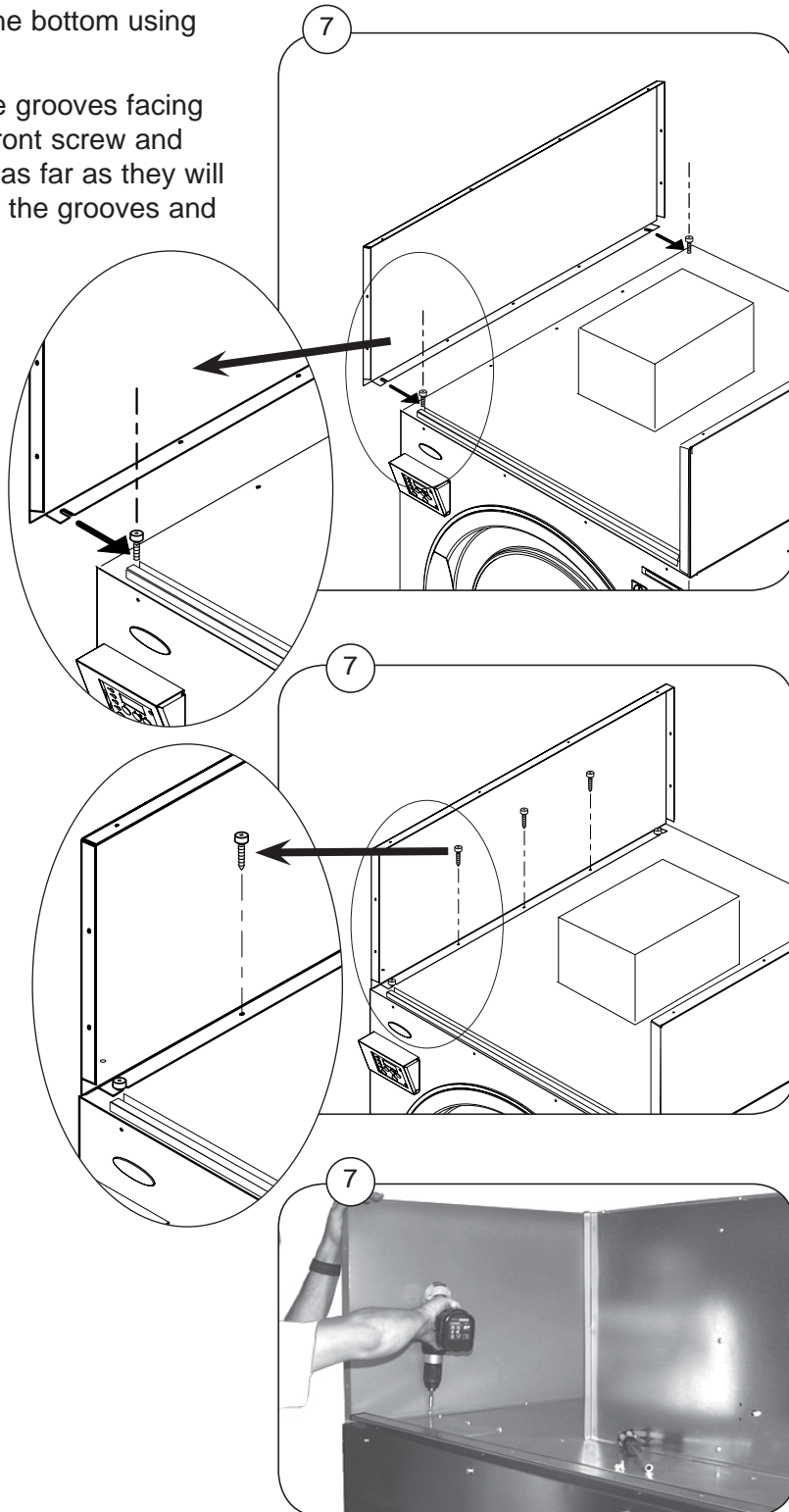

Mounting heating unit

8. Lift air maze into place.
For positioning see sketch.

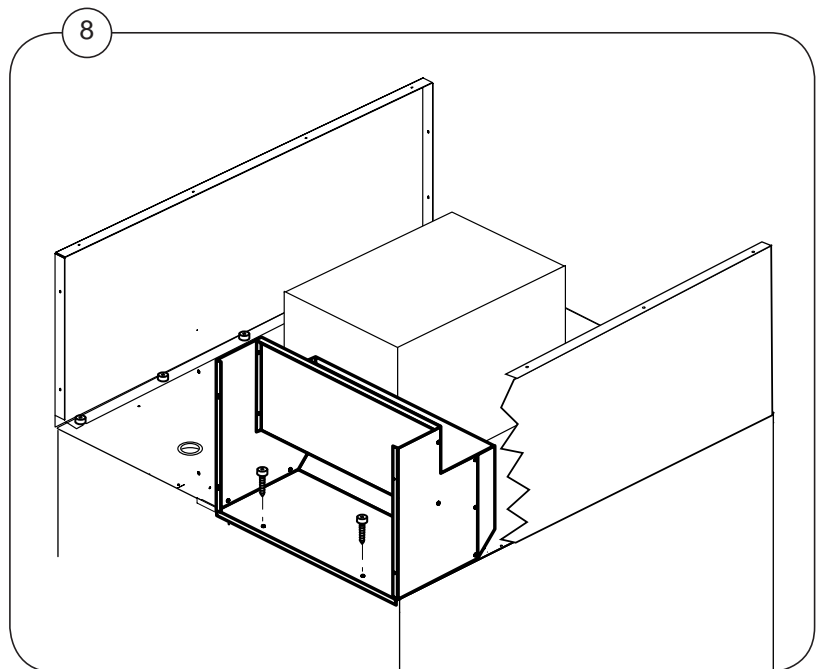
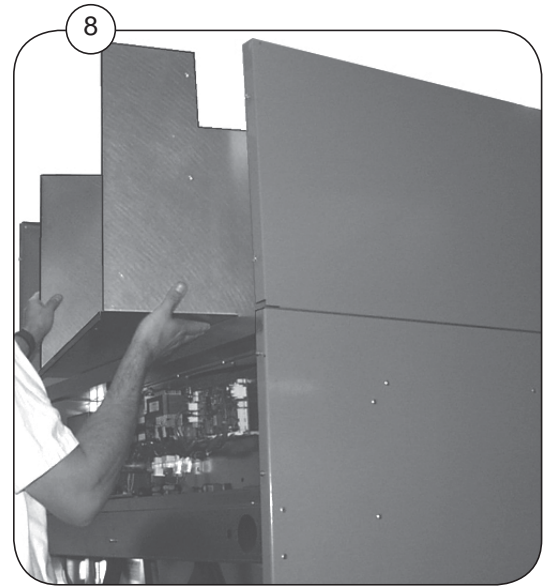

Gas heating unit installation

Mounting heating unit

9. Lift top panel into place.
 10. Fasten maze using 2 screws.
 11. Fasten top panel using 4 screws in each side.
 12. Mount front shutter using 2 screws and locking nuts.
- Lock front shutter on the front using 2 screws.

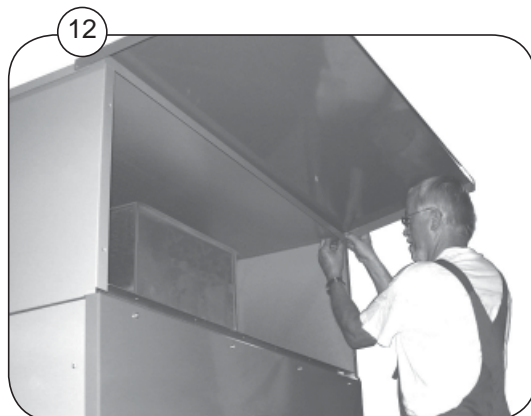
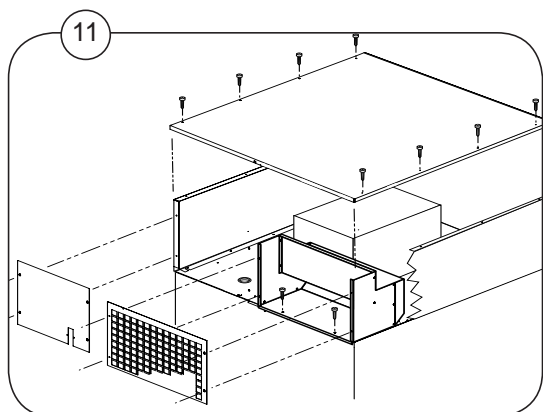
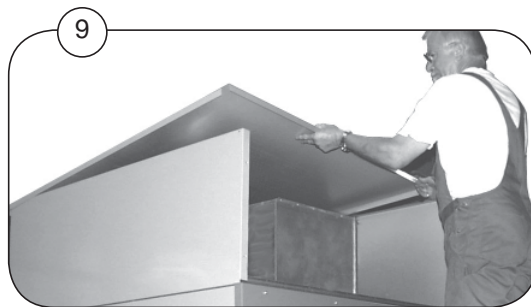

Mounting heating unit

13. Mount the supply disconnect, which is mounted on the console, in its place on the component unit using 4 screws. Place the multiple plug in connector ***A***.
14. and 15. Lead multiple plug from the gas control down through the cable gland to the component unit and place it in connector ***B***. Fasten the wires using cable strips.
16. Place electrical supply disconnect grip in its place.

Electric connection

See installation manual for the dryer, section regarding electric connection.

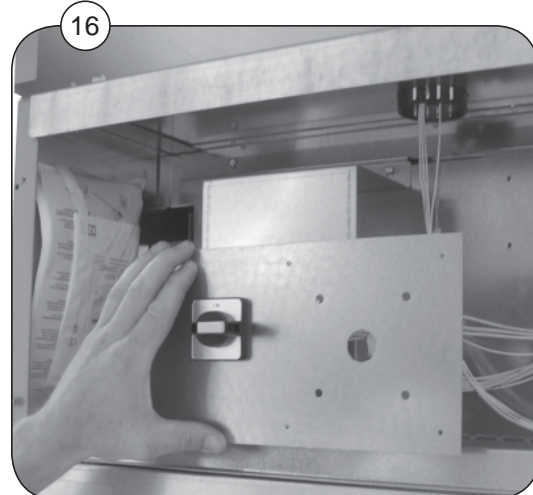
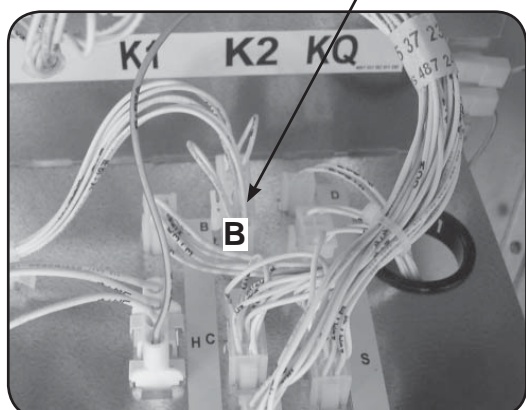
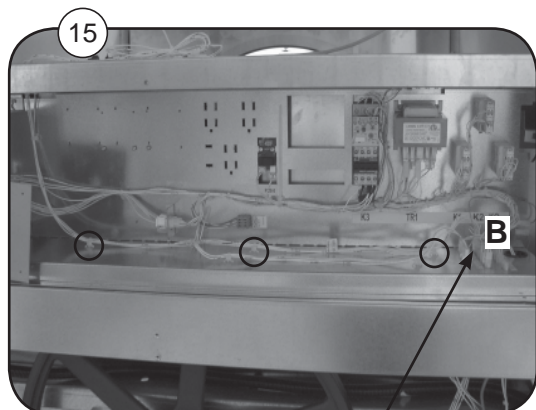
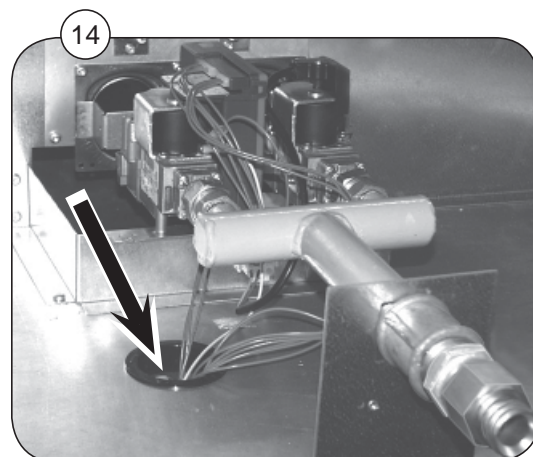
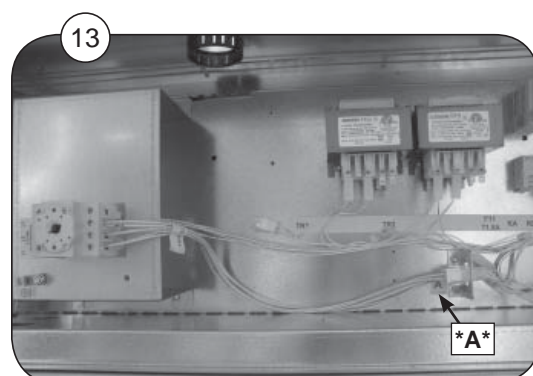

Gas heating unit installation

Mounting heating unit

17. Mount the back panels **A**.

When mounting the component unit back panel **C** its top edge must be tilted under the basic dryer top panel.

18. A: 2 back panels: Heating unit (6 screws)

B: Top panel: Basic dryer

C. Back panel: Component unit (6 screws)

19. Screw the supply disconnecter into the back panel using 6 screws.

Note! Check that the supply disconnecter can connect and disconnect the power.

20. Connect gas supply.

Mount a manual shut-off valve on the gas pipe upstream from the dryer.

See installation manual for more information on gas installation and gas pressure.

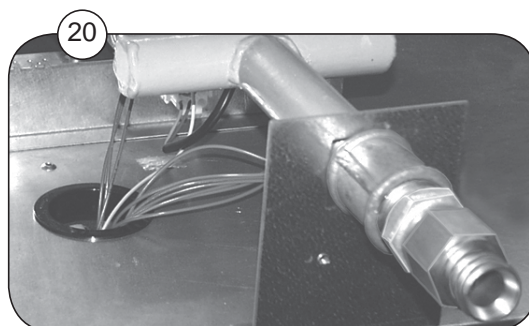
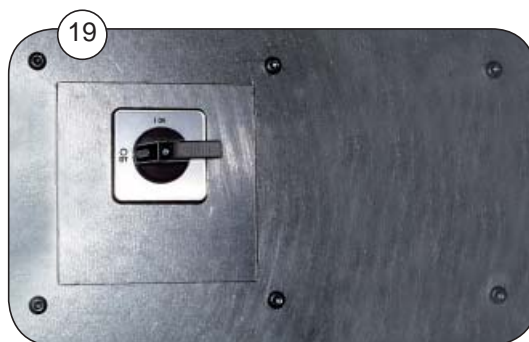
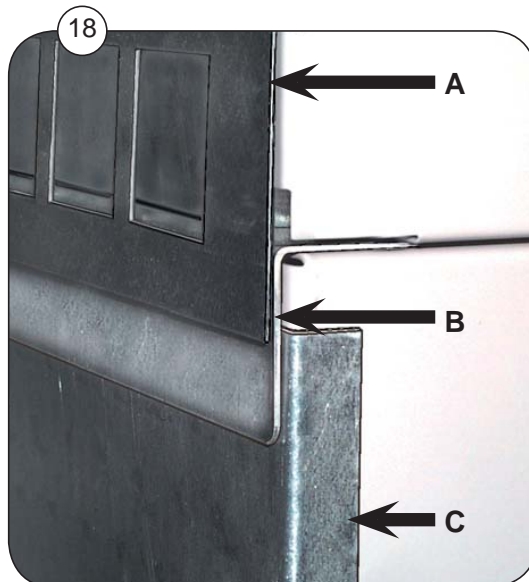
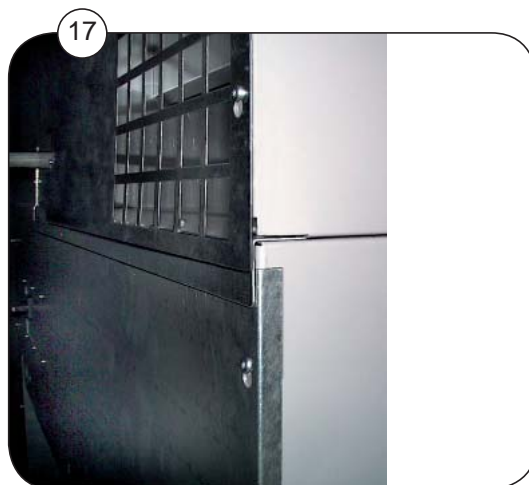

Mounting equipment for Sliding Door

(continued from page 9)

1. Mount brace **A** using 6 screws.
Mount the 2 angle braces **B** using 2 screws in each one.
2. Mount side panels **C** from above and push them down as far as they will go.
3. Mount screws **E** in order to lock the side panels (1 screw in each side).

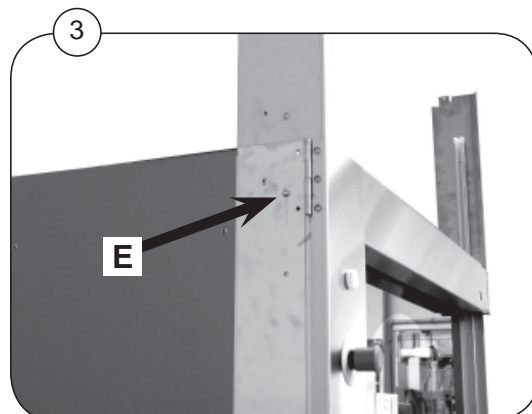
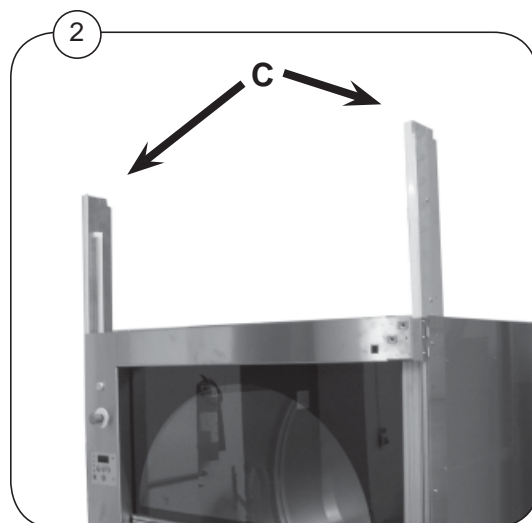
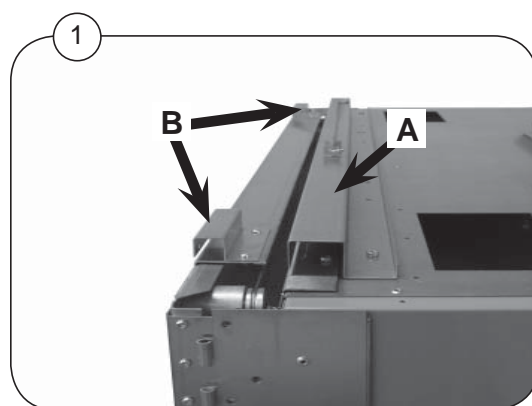

Mounting equipment for Sliding Door

4. Mount side panels as shown on page 10.
The remaining mounting is shown on page 11.
5. Check that the doors slide open easily. A ready mounted dryer with Sliding Door.

Note! It is important that the mounting is carried out carefully, vertical and level as this influences the movement of the Sliding door.



Contents

Installation: Electric heating heating unit

Mounting electric heating unit.	20
Mounting equipment for Sliding Door	28

Note! The procedure when mounting the heating unit is the same on dryers with standard door and with Sliding Door. In this manual all pictures show a standard door except from pages relating specifically to Sliding Door.

The manufacturer reserves the right to modify design and material specifications without notice.

Mounting electric heating unit

Heating unit

The heating unit is to be mounted on top of the dryer.

It is recommended that the mounting is carried out by two persons.

Use the supplied screws.

Unpacking

Unpack the heating unit.

1. Note! During transport side panels and brace are placed in the back of the dryer.

Mounting heating unit

2. Remove top plate for the heating unit from the top of the dryer where it is placed during transport.
3. Demount the two top back plates on the dryer.

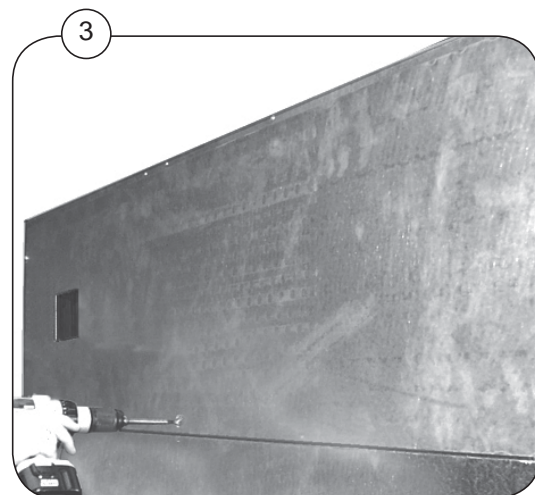
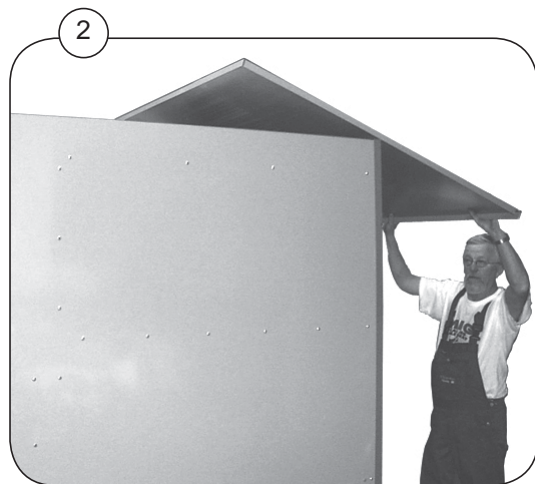
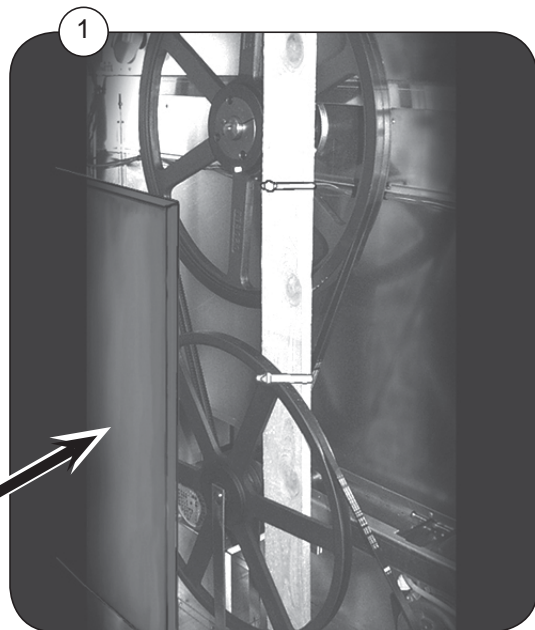

Mounting heating unit

4. Check that the electric heating box is not damaged during transport.

Check that wiring connections and terminals are not bent or defective so there is no risk of short-circuiting.

5. During transport the contactor console is only fastened loosely, now turn it and fasten it on the side using two screws **A**.
6. Lift electric heating box and place it on top of the dryer.

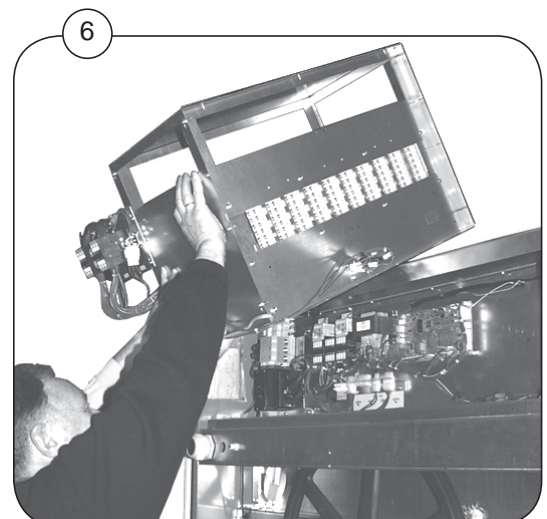
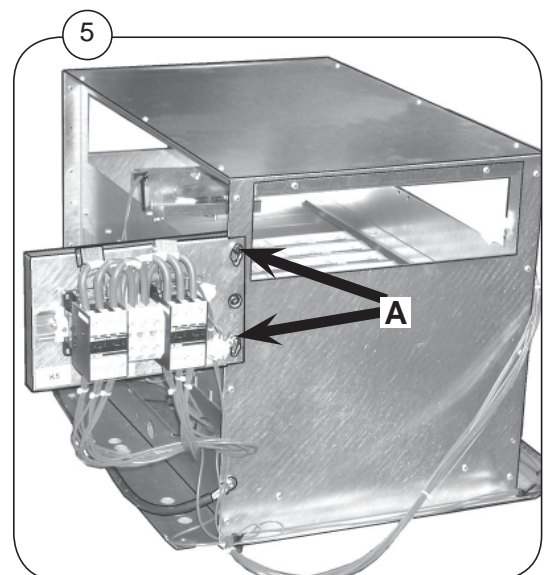
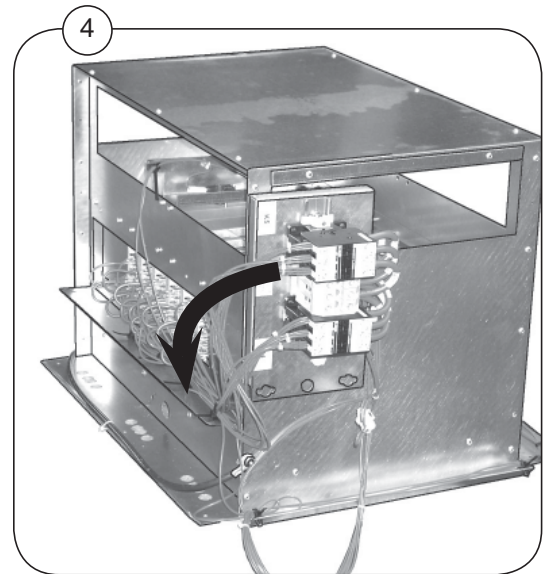

Electric heating unit installation

Mounting heating unit

7. Fasten electric heating box using 10 screws.

8. Fasten brace **A** using 6 screws.

Note! If the dryer has Sliding Door **SD**, go to page 28 before carrying out step 9.

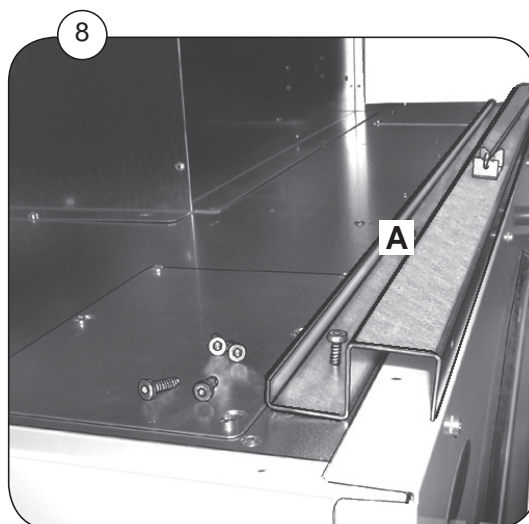
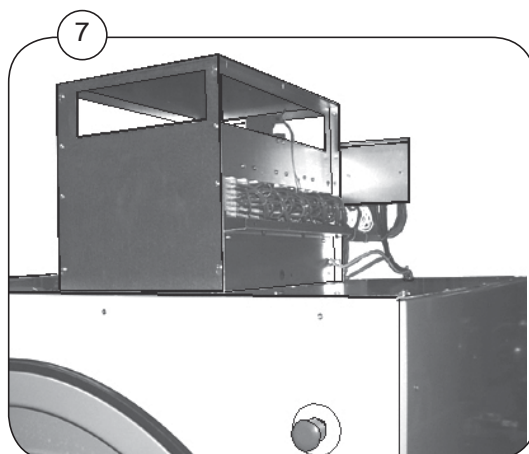

Electric heating unit installation

Mounting heating unit

- Fasten each side panels to the bottom using 5 screws.
9. Turn the side panels with the grooves facing downward. First fasten the front screw and then the back screw but not as far as they will go. Mount the side panels in the grooves and fasten them.

10. Fasten the last 3 screws.

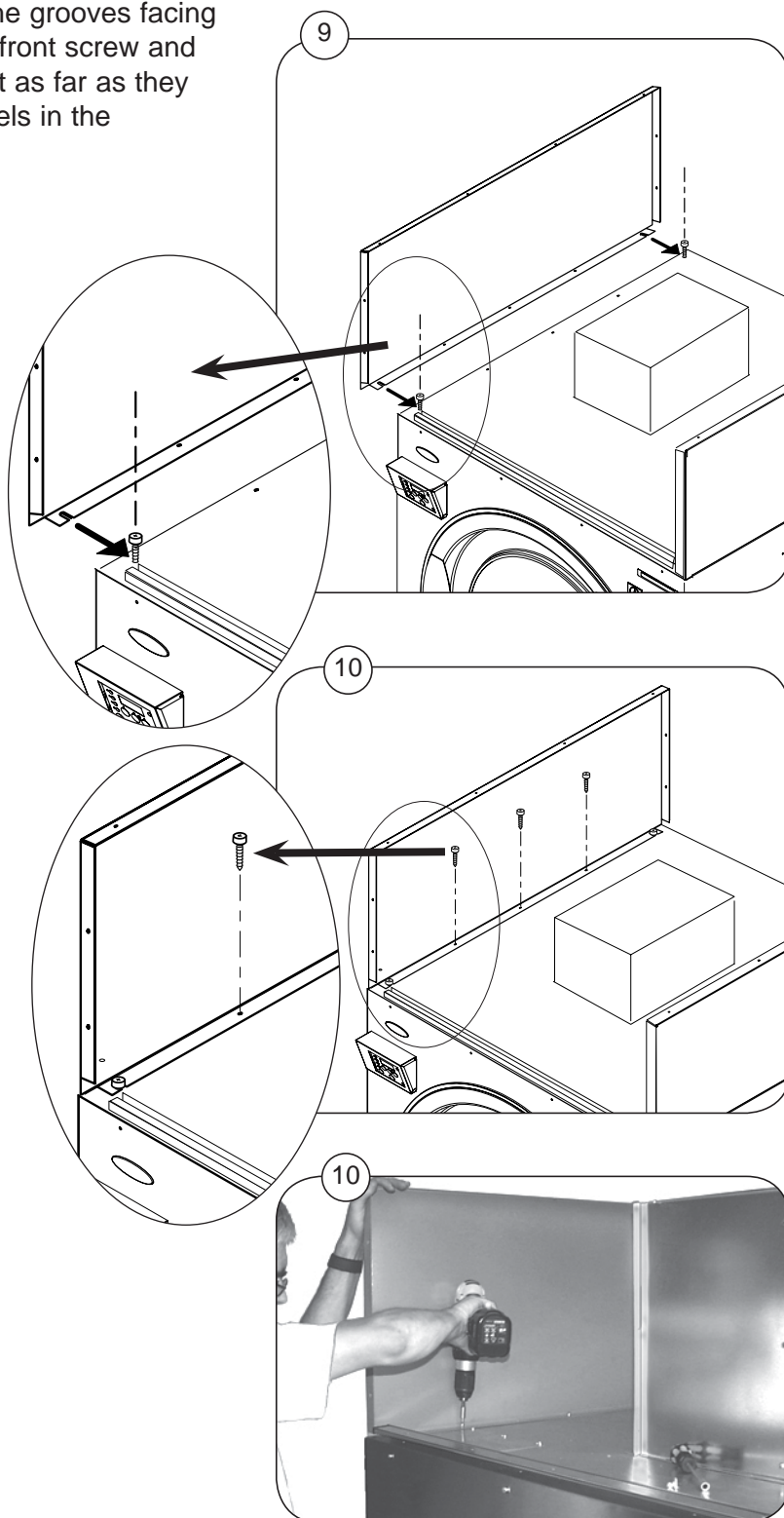

Electric heating unit installation

Mounting heating unit

11. Lift air maze into place.
For positioning see sketch.

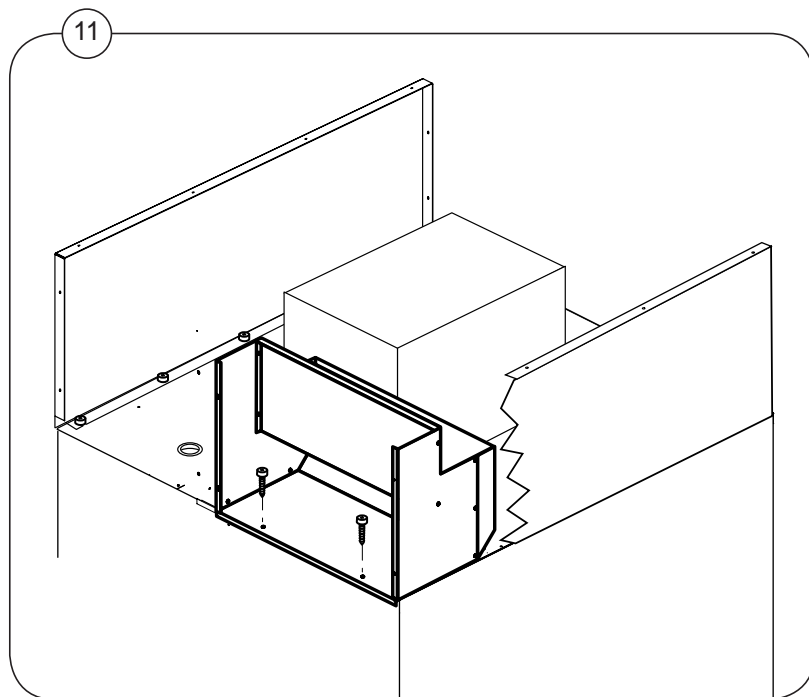
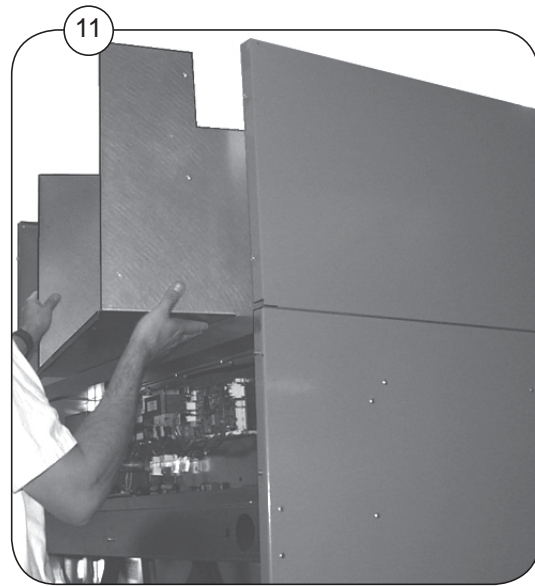

Mounting heating unit

12. Lift top plate into place.
13. Fasten maze using 2 screws.
Fasten top plate using 4 screws in each side.
14. Mount front shutter using 2 screws and locking nuts.
 - Lock front shutter on the front using 2 screws.

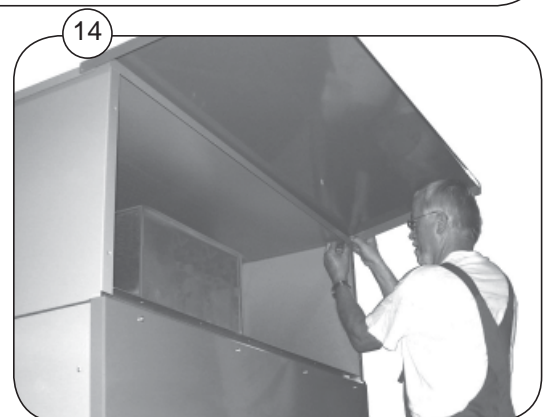
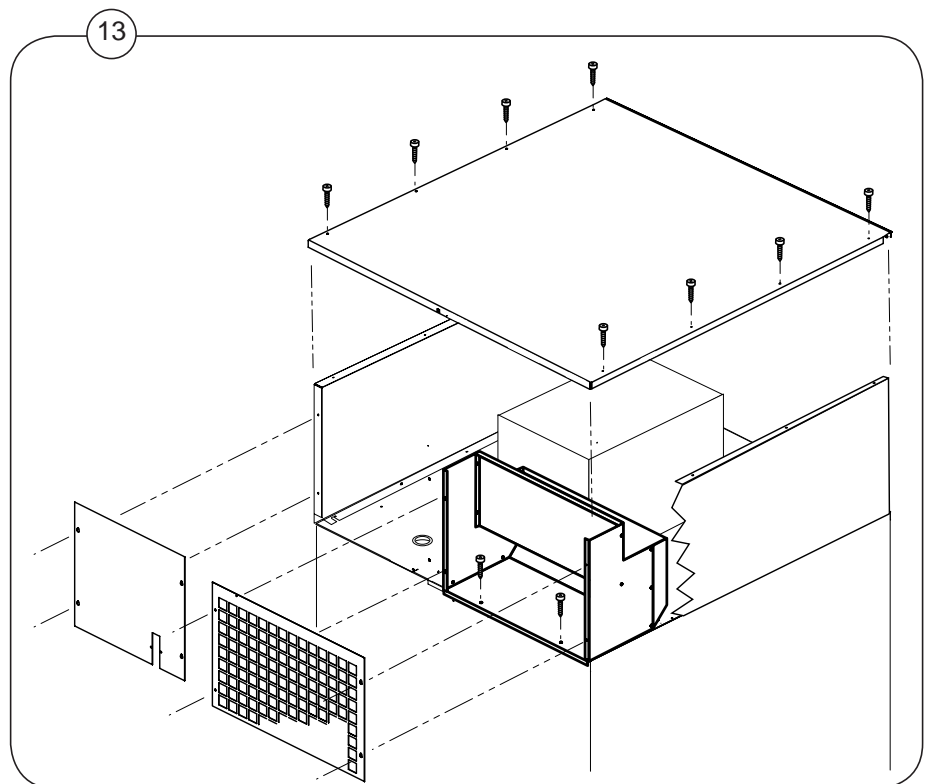
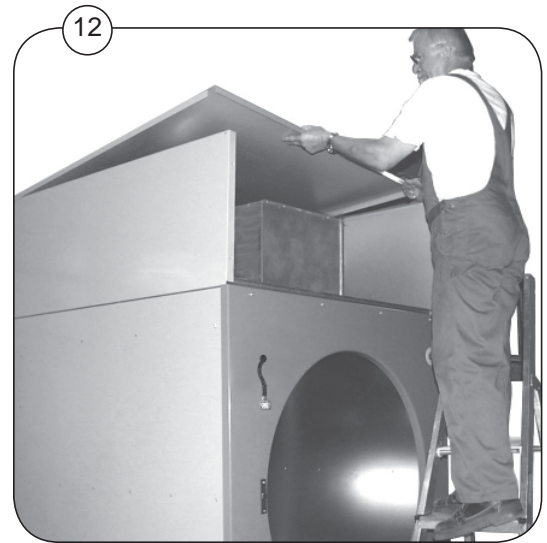

Electric heating unit installation

Mounting heating unit

15. Mount electrical supply disconnecter **D**, which is mounted on the console, in its place on the component unit using 4 screws.
Place the multiple plug in connector ***A***.
16. Lead the multiple plug from the electric heating box down through the cable gland to the component unit and place it in connector ***B***. Fasten the wires using the 3 cable ties and fasten them at the bottom, see fig. 16.
17. Then lead the cables from the supply disconnecter through the cable gland to the electric heating box and place them in L3, L2, L1 on the contactor console **C** - fasten with 2.5 Nm.
18. Lead the earthing conductor from the heating box to GND on the supply disconnecter **D** and fasten with 5 Nm.

Electric connection

See installation manual for the dryer, section regarding electric connection.

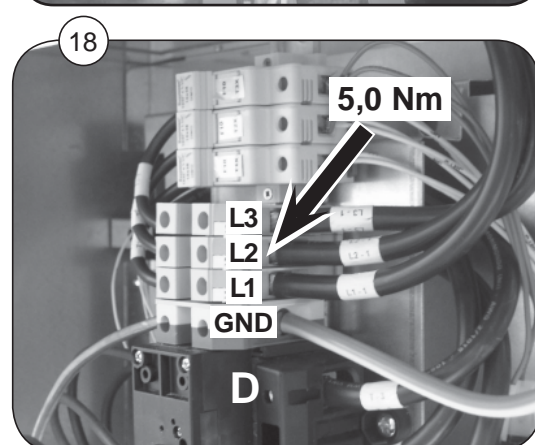
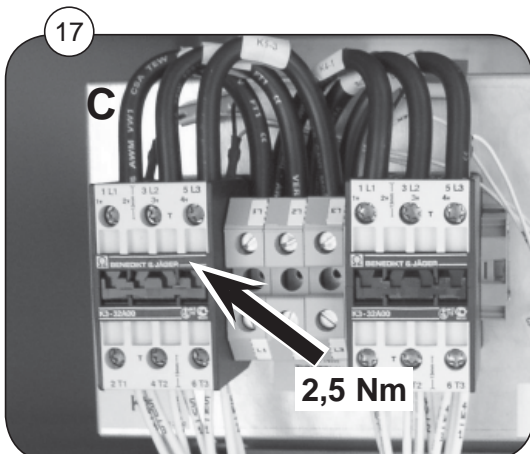
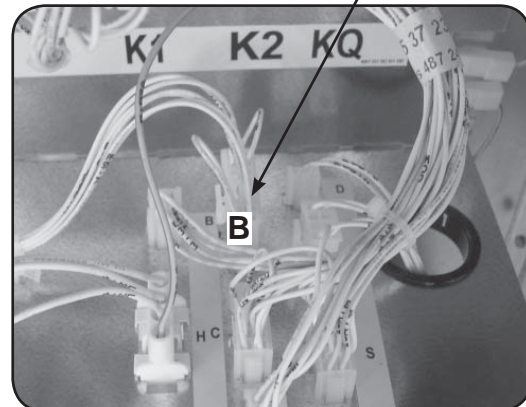
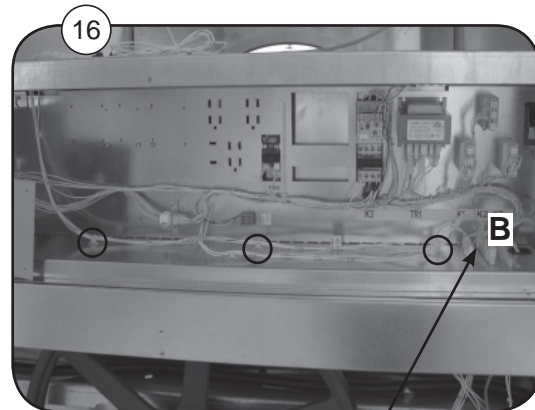
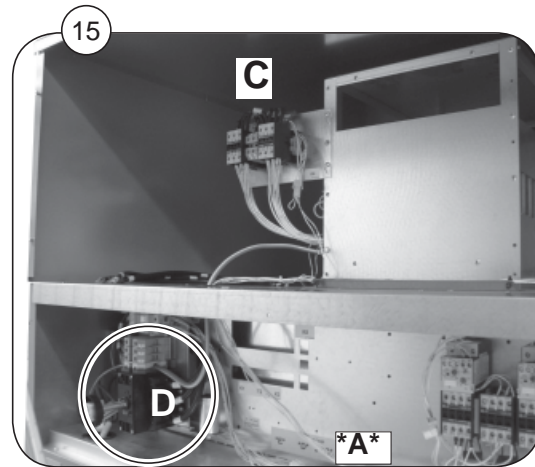

Mounting heating unit

19. Place electrical supply disconnecter handle in its place.

Mount the supplied M63 cable gland **E** and nut.

20. Mount the back plates **A**.

When mounting the component unit back plate **C** its top edge must be tilted under the basic machine top plate.

21. A: 2 back plates: Heating unit (7 screws)

B: Top plate: Basic machine

C. Back plate: Component unit (6 screws)

22. Screw the supply disconnecter into the back plate using 6 screws.

Check that the electrical supply disconnecter can connect and disconnect the power.

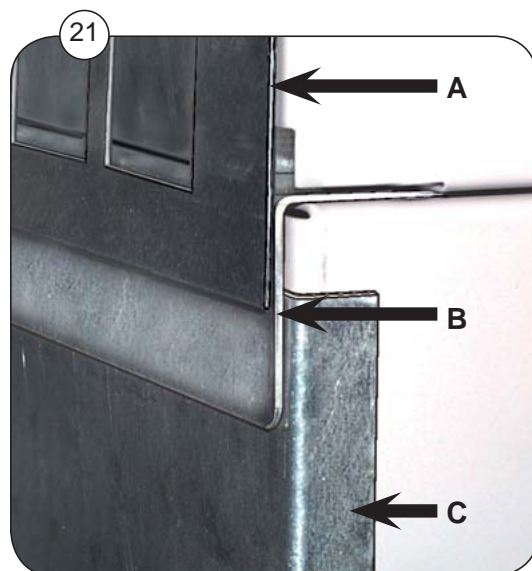
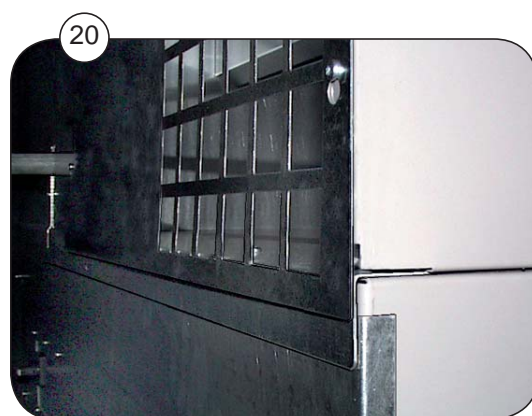
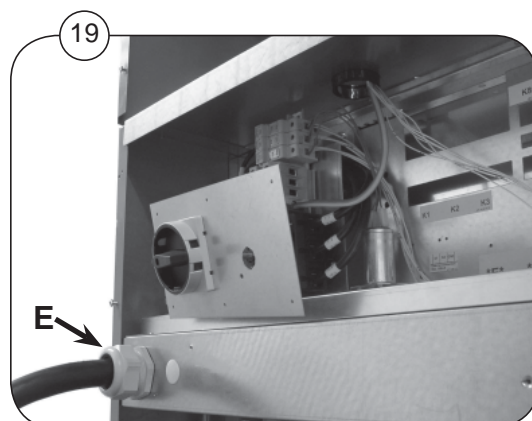

Electric heating unit installation

Mounting equipment for Sliding Door

(continued from page 22)

1. Mount brace **A** using 6 screws.
Mount the 2 angle braces **B** using 2 screws in each one.
2. Mount side panels **C** from above and push them down as far as they will go.
3. Mount screws **E** in order to lock the side panels (1 screw in each side).

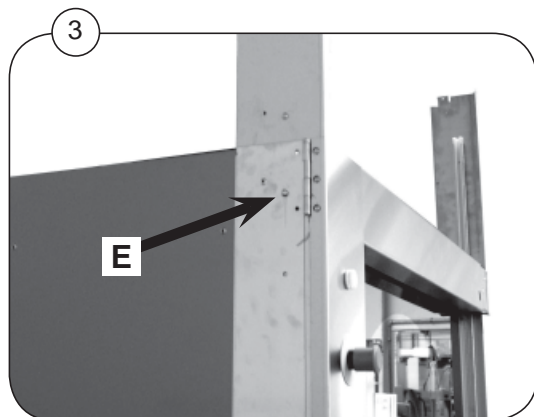
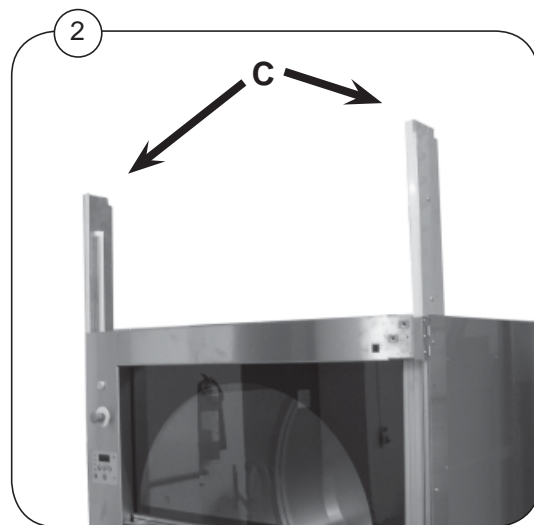
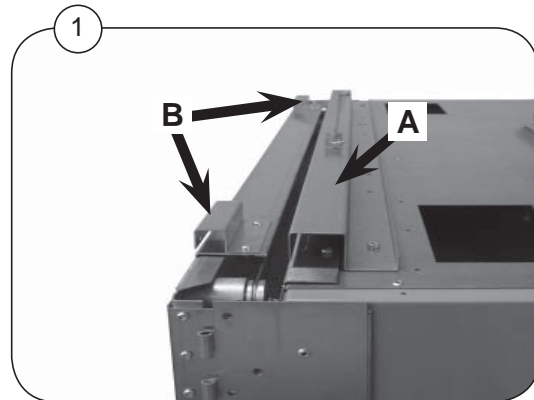

Mounting equipment for Sliding Door

4. Mount side panels as shown on page 23.

The remaining mounting is shown from page 24.

5. Check that the doors slide open easily.
A ready mounted dryer with Sliding Door.

Note! It is important that the mounting is carried out carefully, vertical and level as this influences the movement of the Sliding Door.



Contents

Installation: Steam heating unit

Mounting steam heating unit. 32

Mounting equipment for Sliding Door 40

Note! The procedure when mounting the heating unit is the same on dryers with standard door and with Sliding Door. In this manual all pictures show a standard door except from pages relating specifically to Sliding Door.

The manufacturer reserves the right to modify design and material specifications without notice.

Mounting steam heating unit

Heating unit

The heating unit is to be mounted on top of the dryer.

It is recommended that the mounting is carried out by 2 people.

Use the enclosed screws.

Unpacking

Unpack the heating unit.

1. During transport side plates and brace are placed in the back of the dryer.

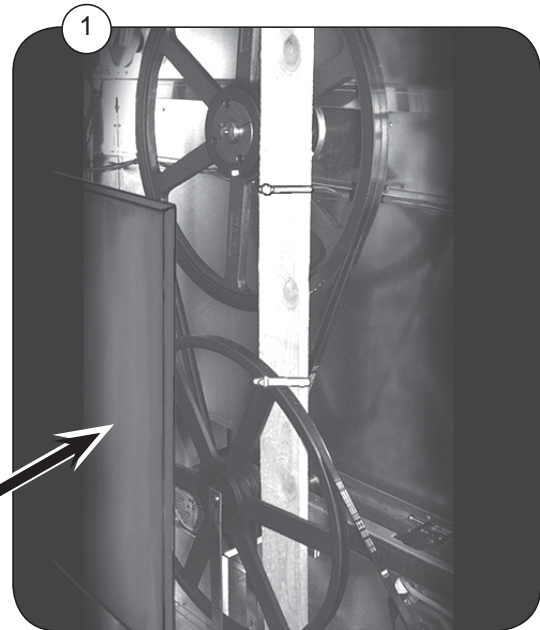

Mounting heating unit

2. Remove top plate for the heating unit from the top of the dryer where it is placed during transport.
3. Demount the two top back plates on the dryer.
4. Lift steam calorifier and place it on top of the dryer.

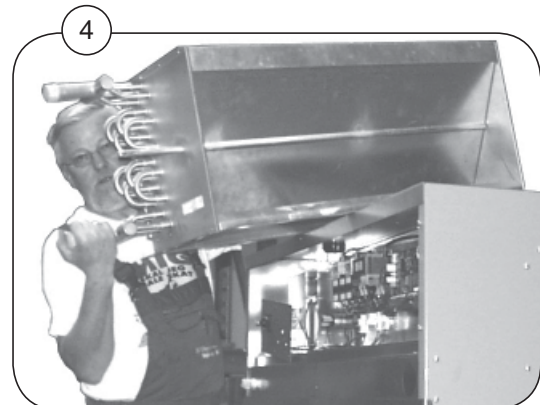
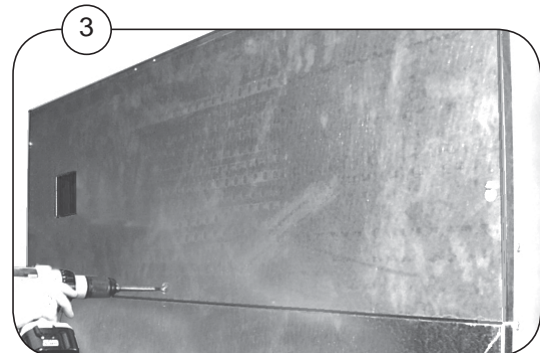
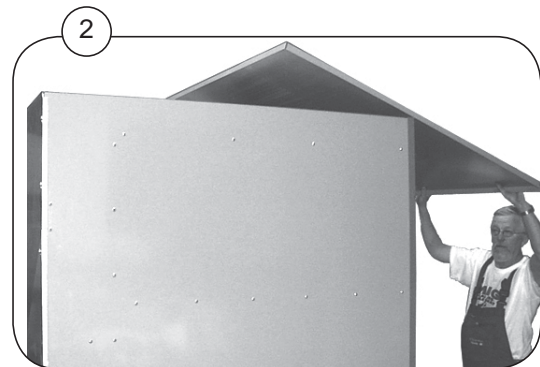

Heating unit

5. Fasten the calorifier with 5 screws in both sides.
 6. Place the actuator box so that the end of the shaft from the steam calorifier is lead into the hole in the actuator.
 7. Note! When tightening the end of the shaft the damper must be open.
 8. Using two tailstock screws tighten the end of the shaft 5 Nm with a 1/8" Allen key (Note! It is a 1/8" key, **not mm key**).
- It is possible to adjust the damper opening by turning the manual declutch lever.

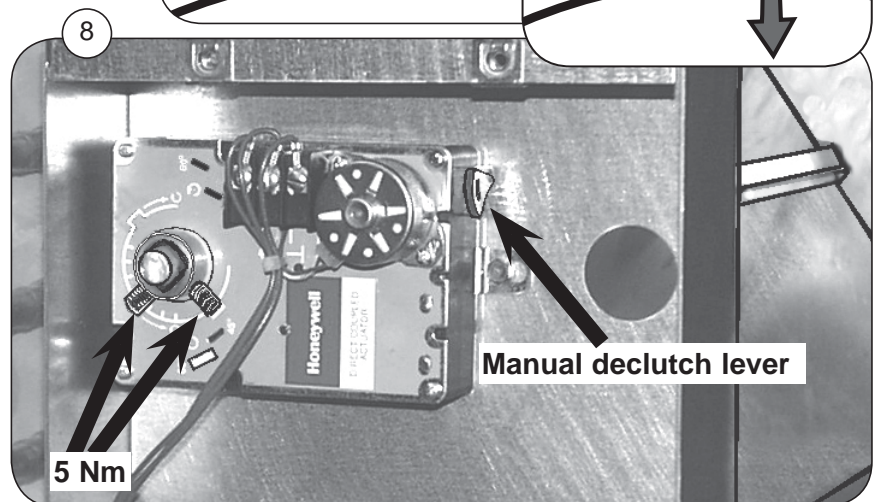
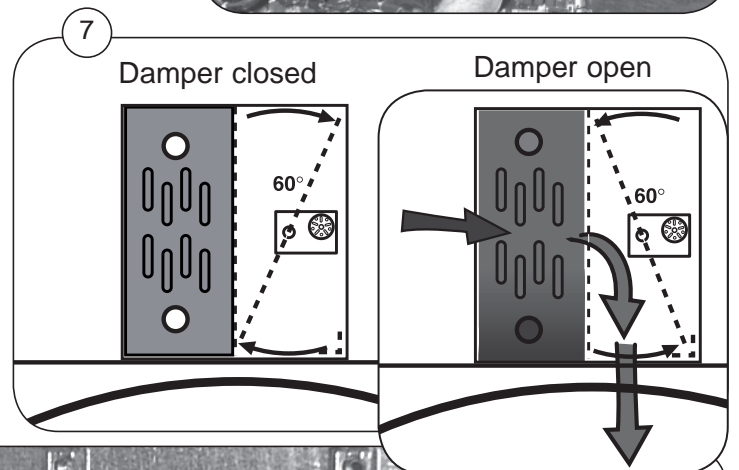
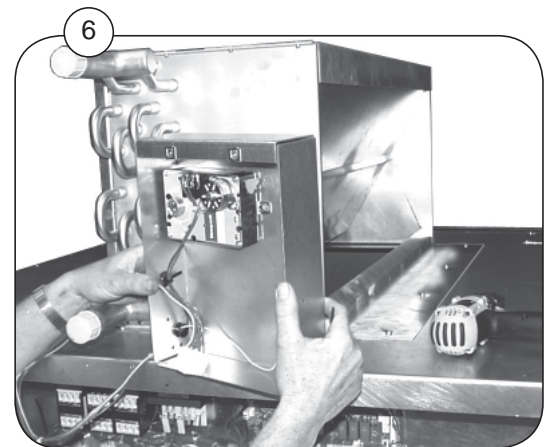
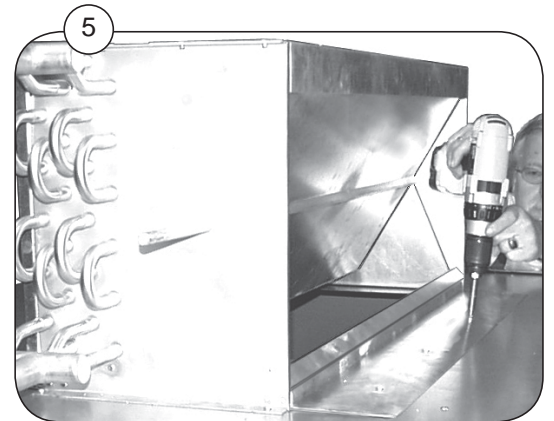

Steam heating unit installation

Heating unit

9. Mount the supply disconnect, which is mounted on the console, in its place on the component unit using 4 screws. Place the multiple plug in connector ***A***.
10. Lead the multiple plug from the actuator down through the cable gland to the component plate and place it in connector ***B***. Fasten the wires with cable strips.
11. and 12. Place the electrical supply disconnect grip in its place.

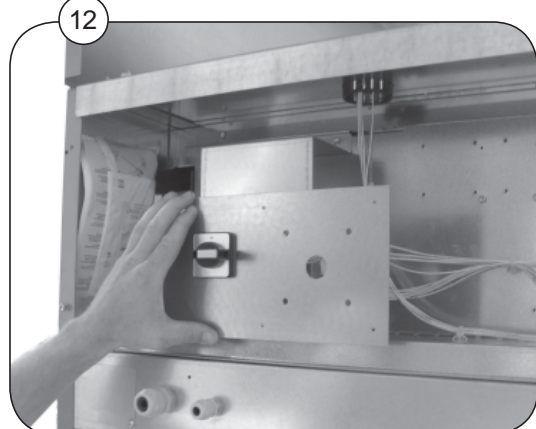
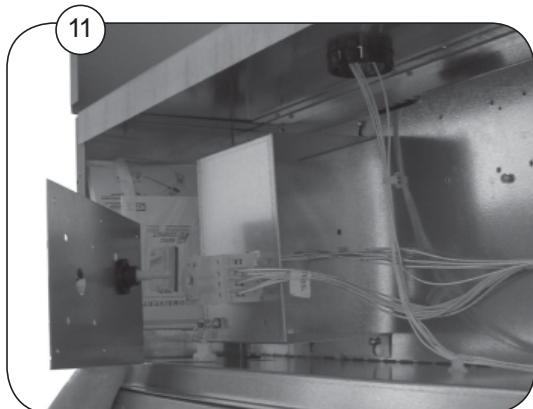
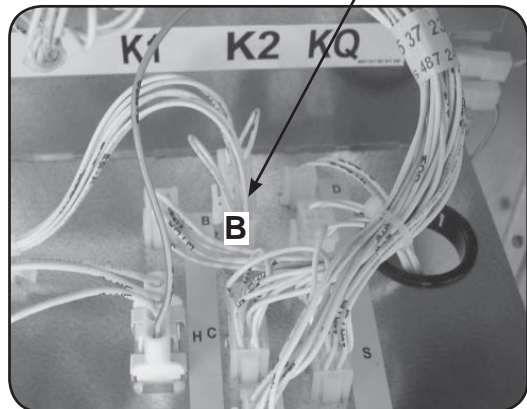
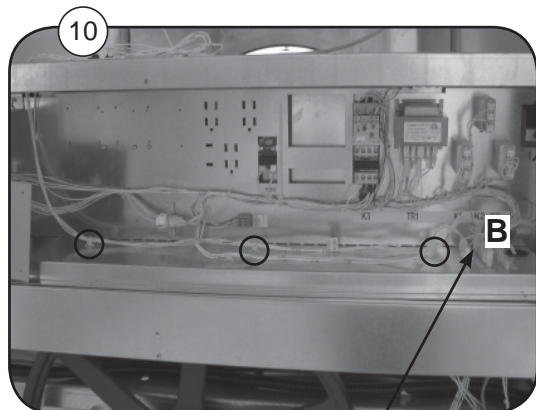
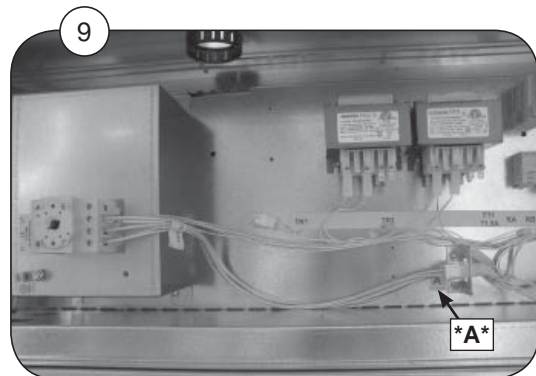

Heating unit

13. Mount the two back plates. When mounting the back plate on the component unit its top edge must be tilted under the basic dryer top plate, see step 21.

- It is possible to mount the wires from the installation before mounting the back plate. See dryer installation manual, section regarding electric connection .

14. Fasten 6 screws around the supply disconnecter in the component unit back plate.

Note! If the dryer has Sliding Door **SD**, go to page 40 before carrying out step 15.

15. and 16. Mount brace **A** right above the front plate and fasten it using 6 screws.

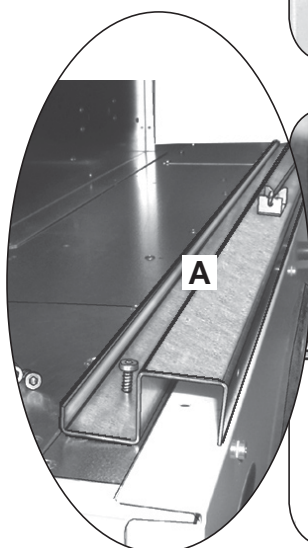
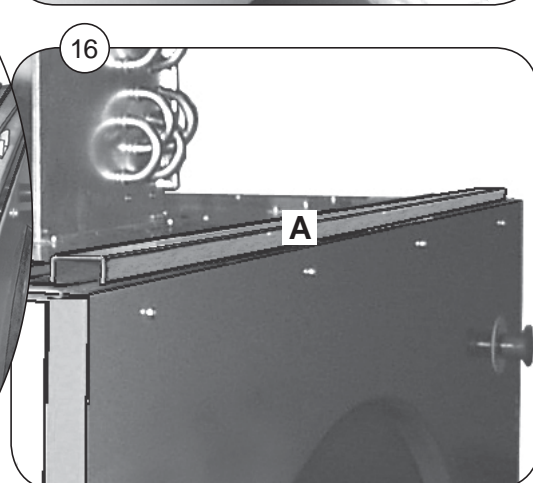
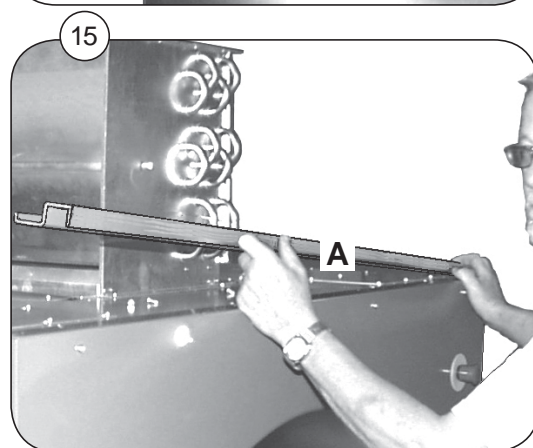
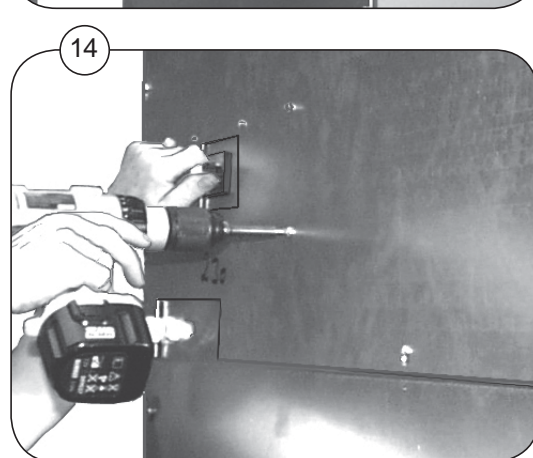
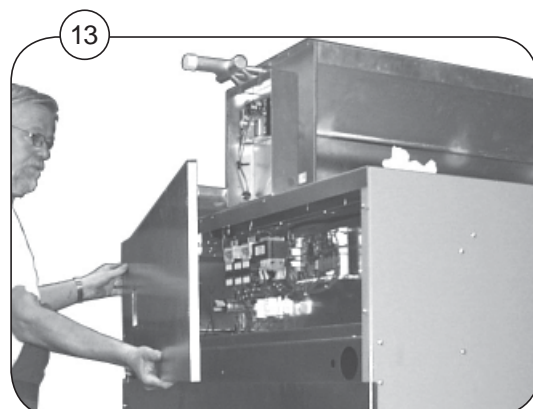

Steam heating unit installation

Mounting heating unit

- Fasten each side panels to the bottom using 5 screws.

17. Turn the side panels with the grooves facing downward. First fasten the front screw and then the back screw but not as far as they will go. Mount the side panels in the grooves and fasten them.

- Fasten the last 3 screws.

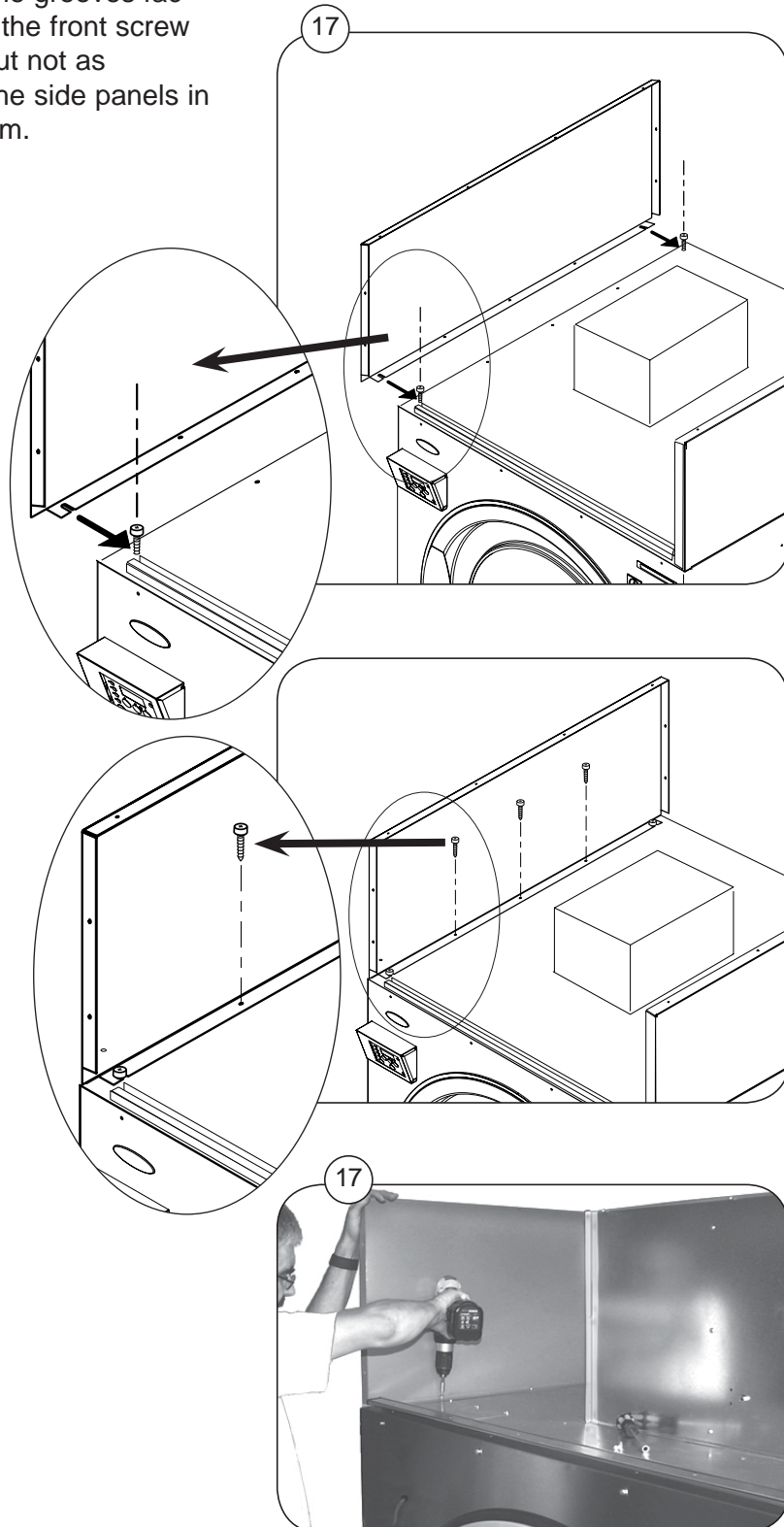

Mounting heating unit

18. Lift air maze into place.
For positioning see sketch.

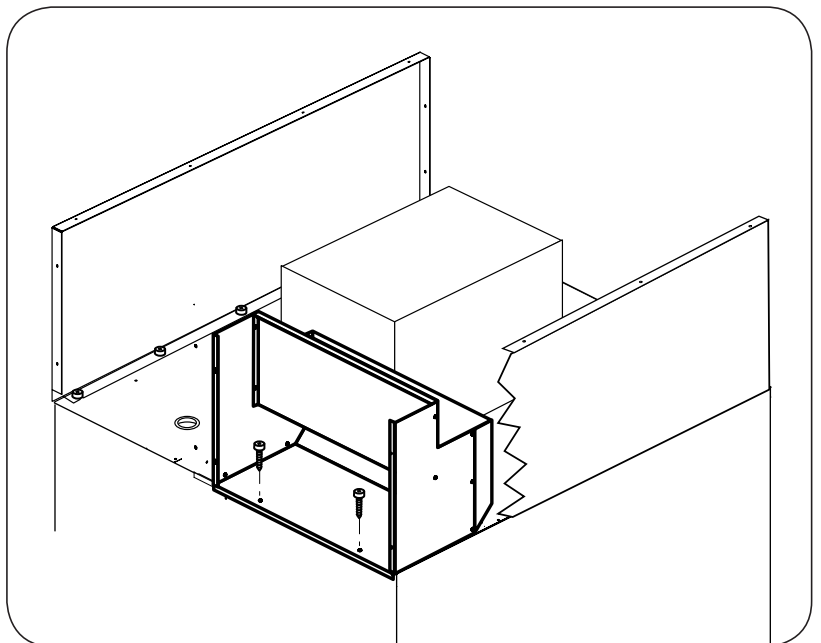
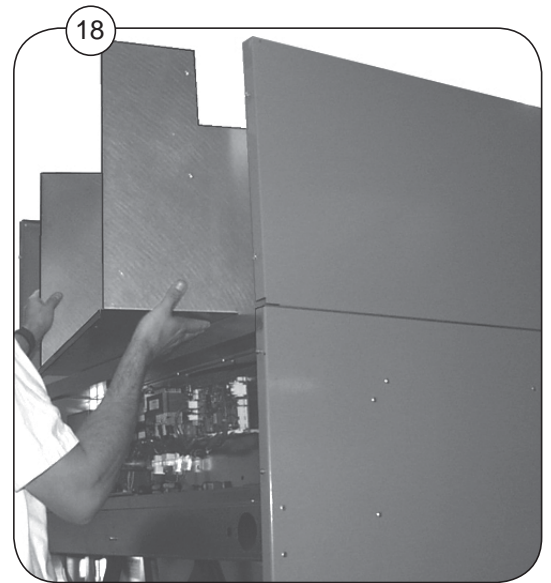

Steam heating unit installation

Mounting heating unit

19. Lift top plate into place.

- Fasten maze using 2 screws. Fasten top plate using 4 screws in each side.

20. Mount front shutter using 2 screws and locking nuts.

- Lock front shutter on the front using 2 screws.

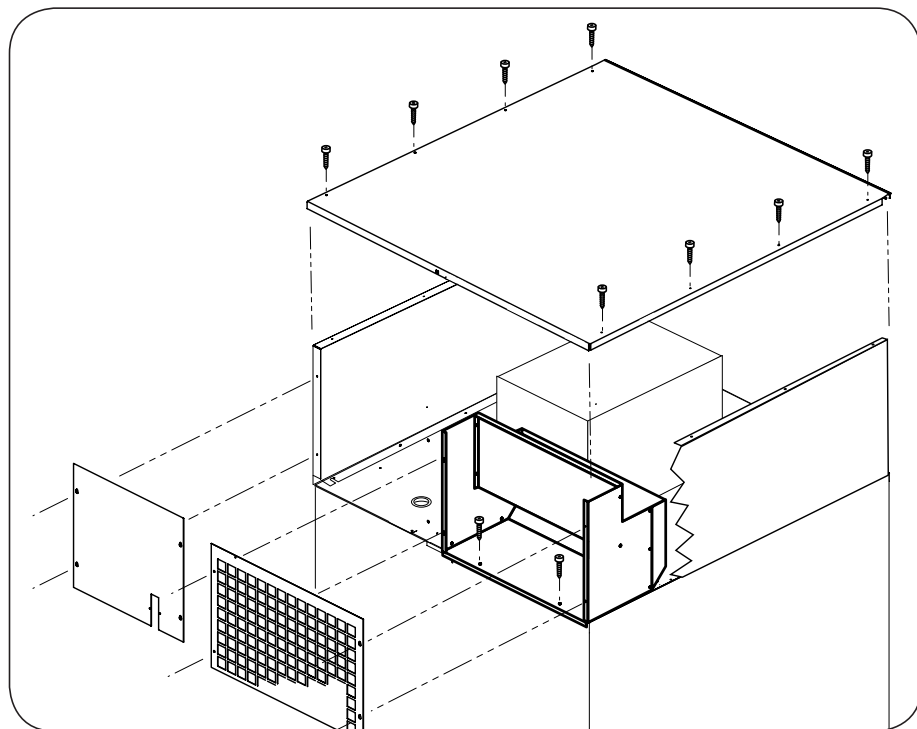
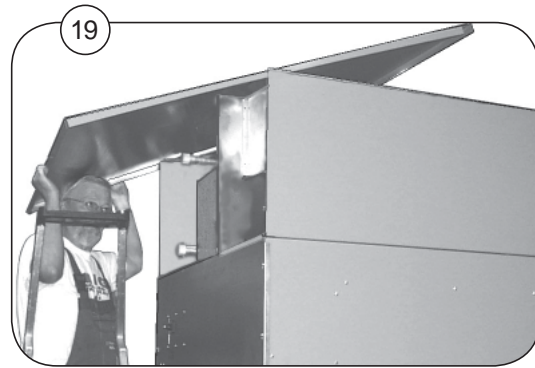

Heating unit

21. Mount the back plates of the heating unit.

A: Back plates: Heating unit (6 screws).

B: Top plate: Basic machine.

C. Back plate: Component unit (6 screws).

22. Connect steam. To install steam see the installation manual:

D = Inlet.

E = Return (condense).

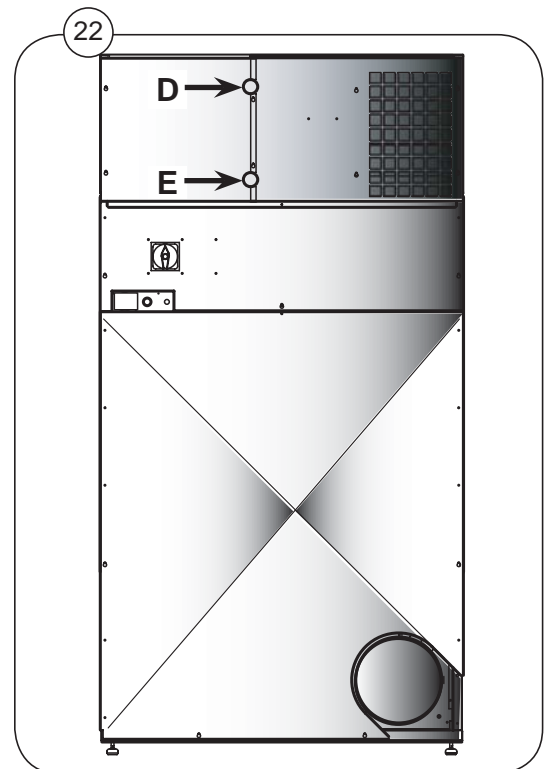
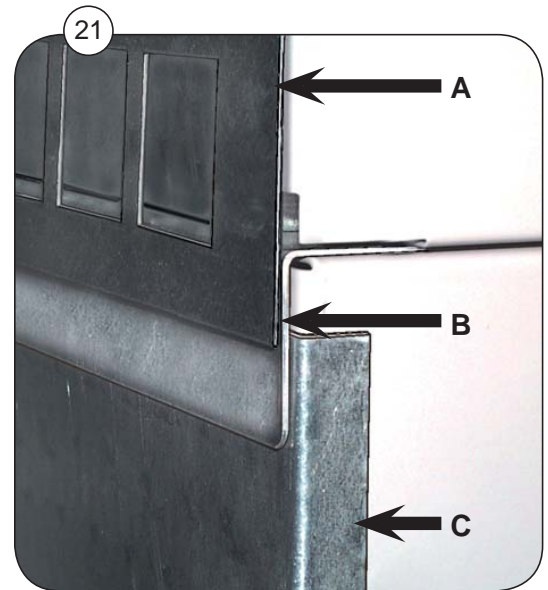

Steam heating unit installation

Mounting equipment for Sliding Door

(continued from page 35)

1. Mount brace **A** using 6 screws.
Mount the 2 angle braces **B** using 2 screws in each one.
2. Mount side panels **C** from above and push them down as far as they will go.
3. Mount screws **E** in order to lock the side panels (1 screw in each side).

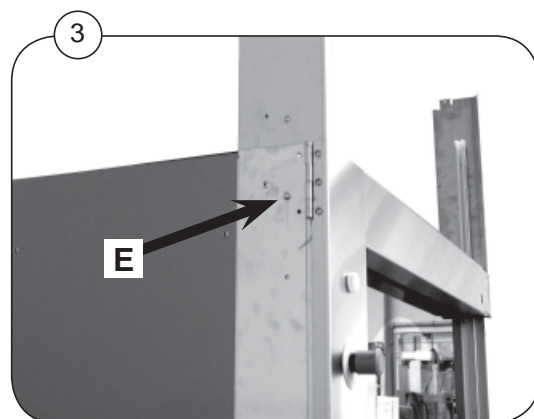
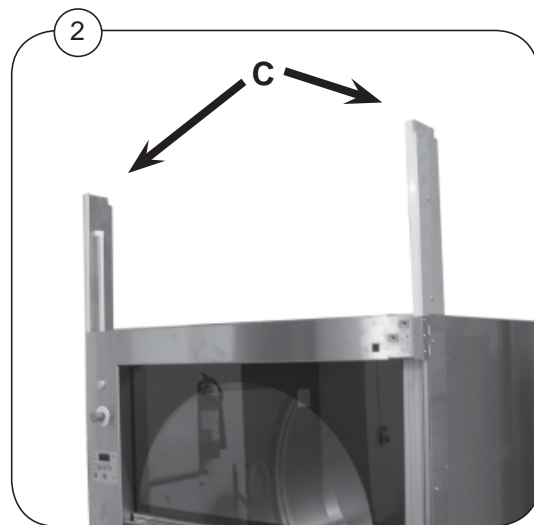
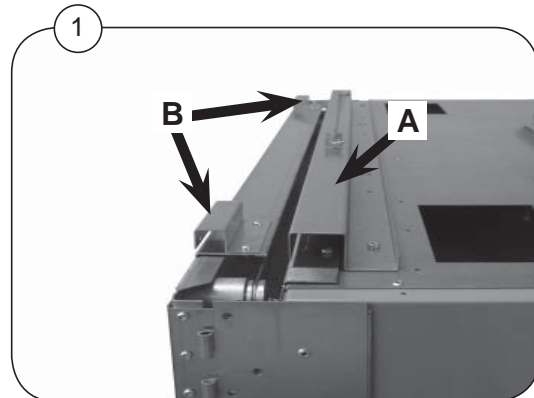

Mounting equipment for Sliding Door

4. Mount side panels as shown on page 36.
The remaining mounting is shown from
page 37.

5. Check that the doors slide open easily. A
ready mounted dryer with Sliding Door.

Note! It is important that the mounting is
carried out carefully, vertical and level as this
influences the movement of the Sliding Door.

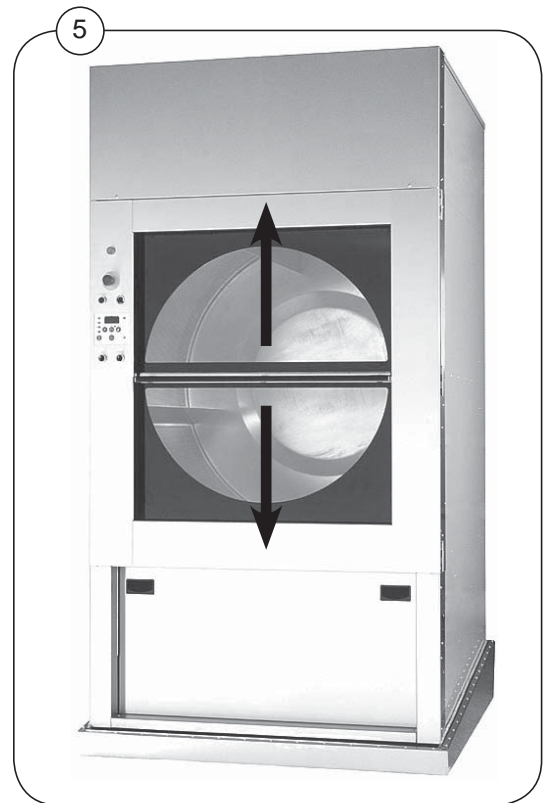

When reliable laundry and wetcleaning equipment is desired, the choice is Wascomat!

The world's oldest and leading manufacturer of commercial laundry equipment for coin laundries, hotels, motels, nursing homes and any other institutional laundry use, and the environmentally safe, wetcleaning “dual-use” systems for drycleaners.

WASCOMAT PROVIDES “PEACE OF MIND GUARANTEE”

Backed by a company that's been in the laundry equipment business for over 100 years and has earned a reputation as the standard of quality worldwide, Wascomat dealers provide:

- Free survey of your laundry needs
- Laundry design and layout
- Quality laundry equipment in a size and model for every need
- Installation, start-up and training
- Worldwide parts and service
- Best warranty in the business
- **“Lease-a-Laundry Program”**, which includes the laundry equipment installation and ongoing service

EXPAND, MODERNIZE, RETOOL OR BUILD A NEW LAUNDRY WITH LOW-COST FINANCING OR LEASING FROM WASCOMAT*

With Wascomat/Viking financing or leasing you can obtain and install durable, efficient, state-of-the-art Wascomat washers, dryers and non-polluting, environmentally-friendly wetcleaning equipment to meet all anti-pollution regulations.

For more information and to apply for financing or leasing, call Viking Financial Services LLC 1-800-645-2209

Wascomat provides efficient, quality washers, dryers, flatwork ironers and non-polluting wetcleaning equipment.

FRONT-LOAD WASHER MODELS

Solid and soft-mount, coin operated and commercial laundry washers in standard, high and ultra-high extract models. Designed for long life and efficient water and energy use. **Available from 18 to 250 lb. capacities.**

SIDE-LOAD WASHER MODELS

Pullman, Side-Load, Barrier and Clean Room washer models with high 300 to 350 G-Force extraction, designed and built for long, trouble-free life and big water and energy savings. **Available from 55 to 250 lb. capacities.**

GAS EFFICIENT DRYER MODELS

Coin operated and commercial energy and gas efficient, user friendly TD dryer models with optional unique Wascomat Residual Moisture Control (RMC). **Available in a size and model for every laundry need.**

AUTOMATIC FLATWORK IRONERS

A unique one-operator fully automatic, labor saving, ironer that does it all: feeds, irons, folds, stacks and counts. Also available in fully and semi-automatic models **in a size and model for every laundry need.**

FOR PARTS & CUSTOMER SERVICE YOU CAN DEPEND ON WASCOMAT & ITS DEALERS



WASCOMAT NON-POLLUTING WETCLEAN EQUIPMENT

The best alternative to Perc, uses water and complies with OSHA, EPA and all other environmental, anti-pollution regulations. Wascomat state-of-the-art wetclean technology eliminates all pollution concerns and provides the best wetcleaning and washing results. **Available in a size and model for every wetcleaning need.**

With the push of a button, the unique **Wascomat "Dual-Use" Wetcleaner** converts to an ideal laundry washer for washing shirts, comforters, drapes, all other washable garments and cleaner's wash-dry-fold customer service.



WASCOMAT PROVIDES THE BEST CUSTOMER SERVICE WITH EXPERIENCED WORLDWIDE CUSTOMER SUPPORT, WITH AN OVER 100-YEAR TRACK RECORD.

WASCOMAT/VIKING FINANCIAL SERVICES PROVIDES LOW COST FINANCING AND LEASING* FOR YOUR BUSINESS GROWTH.

For more information call Wascomat at 516-371-4400



Wascomat Laundry Equipment

The Standard of Quality for Over 100 Years!